

CharniRO®

STRONG-ARM



2 TONNE FOLDING CRANE

MODEL NO: CFC2000B

PART NO: 7611006

ASSEMBLY & USER INSTRUCTIONS

UK
CA | CE

ORIGINAL INSTRUCTIONS

GC0925

INTRODUCTION

Thank you for purchasing this CLARKE Folding Crane.

Before attempting to operate the product, it is essential that you read this manual thoroughly and carefully follow all instructions given. In doing so you will ensure the safety of yourself and that of others around you, and you can also look forward to the stand giving you long and satisfactory service

SPECIFICATIONS

Max Capacity (SWL)		2000 kg (2 Tonne)
Net Weight		88 kg
Overall Width at legs Height (arm horizontal) Length		1060 mm 1570 mm 1590 mm
Dimensions (folded)	L x W x H	530 x 660 x 1480 mm
Jib Positions	Position 1	
	Lift Capacity	2000 kg
	Jib length (horizontal/extended)	865 /530 mm
	Max Lifting Height	1605 mm
	Position 2	
	Lift Capacity	1500 kg
	Jib length (horizontal/extended)	1035 /700 mm
	Max Lifting Height	1685 mm
	Position 3	
	Lift Capacity	1000 kg
	Jib length (horizontal/extended)	1205 /870 mm
	Max Lifting Height	1765 mm
	Position 4	
	Lift Capacity	500 kg
	Jib length (horizontal/extended)	1375 /1040 mm
	Max Lifting Height	1850 mm

SAFETY PRECAUTIONS

ALWAYS read the instructions before setting up the equipment and before use. Failure to heed these warnings may result in damage to the equipment or serious personal injury.

WORKPLACE SAFETY

1. **ALWAYS** inspect the crane before use to ensure it is correctly assembled and in good condition and replace any damaged or worn parts.
2. Only use the crane on a flat, solid, level surface that is capable of bearing the weight of the loaded crane, preferably concrete. **NEVER** work on soft/unmade ground as the castors may sink in.
3. Ensure the crane operator is trained in both operation & safety aspects of its use.
4. **DO NOT** allow personnel to use the crane unless they have read these safety precautions.
5. Use the crane in a suitable, well lit work area which is clean, tidy and free from unrelated items.
6. **DO NOT** use the crane when you are tired or under the influence of alcohol, drugs or intoxicating medication.
7. Ensure all bystanders keep at a safe distance whilst the crane is in use.
8. **DO NOT** over-reach. Keep your proper footing and balance at all times.
9. Safety equipment such as gloves and non-skid safety shoes will reduce personal injuries.

INSPECTION BEFORE USE

1. **ALWAYS** visually inspect the crane before use, to ensure that all parts are correctly located and secure. Check for cracks, deformation or other signs of damage or worn parts and check the castors for damage. **DO NOT** use the crane unless it is totally sound.
2. Check castors to ensure they move freely without undue wear to their pivots, and that the wheels are not cracked or damaged.

SAFE OPERATING PRACTICE

1. Only use chains, slings, hooks etc. with a rated capacity equal to, or greater than that of the load. Check that they are secure and will not slip under load.
2. **NEVER** exceed the safe working load capacities specified on the jib for each position (as marked on the jib).
3. **ALWAYS** fully lock the jib and legs into position before lifting.

4. Lower the load as much as possible before moving the crane. **DO NOT** use the crane to transport loads over long distances.
5. **DO NOT** allow the load to swing or drop suddenly whilst moving or lowering.
6. **DO NOT** use this crane to lift people.
7. **DO NOT** work under any raised load.
8. **NEVER** climb on, or attempt to ride on the crane.
9. Take care not to trap your fingers in the adjustable parts of the crane.
10. Due to the weight of the loaded crane, the help of an assistant will be beneficial when moving the crane around.
11. This is a heavy item (88kg). Take care when moving or folding away.
12. **NEVER** attempt to move a loaded crane across a floor having cracks, pebbles, or other obstacles which might impede its movement.
13. To move a loaded crane, always manoeuvre it from the operators side.

CARE OF THE CRANE

1. Ensure that the crane is properly maintained at all times and that no corrosion is allowed to weaken any components.
2. When replacing parts, use only those supplied by CLARKE International.
3. If the crane has been subjected to an abnormal load or shock, it should be removed from service immediately and fully inspected by qualified personnel.
4. **NEVER** tamper with the crane or modify it in any way as this could prove to be dangerous and will invalidate the guarantee. Only use the crane for the purpose for which it is intended.
5. The components of this crane are designed to withstand the rated capacity. **DO NOT** substitute any other components or exceed the rated capacity of the crane.
6. If the load capacity decal becomes worn or illegible, contact Clarke Parts and Service department for a replacement.

GUARANTEE

This CLARKE product is guaranteed against faulty manufacture for a period of 12 months from the date of purchase. Please keep your receipt as proof of purchase.

This guarantee is invalid if the product is found to have been abused or tampered with in any way, or not used for the purpose for which it was intended.

Faulty goods should be returned to their place of purchase, no product can be returned to us without prior permission.

This guarantee does not effect your statutory rights.

UNPACKING

Unpack the components on a clean flat area of hard standing and ensure that all parts are present according to the packing list/components diagram.

Bolts/nuts and washers including R-clips will be in a separate package.

Visually inspect all components to ensure that no damage was suffered in transit. Any deficiencies should be reported to your CLARKE dealer immediately.

FRAME COMPONENT PARTS

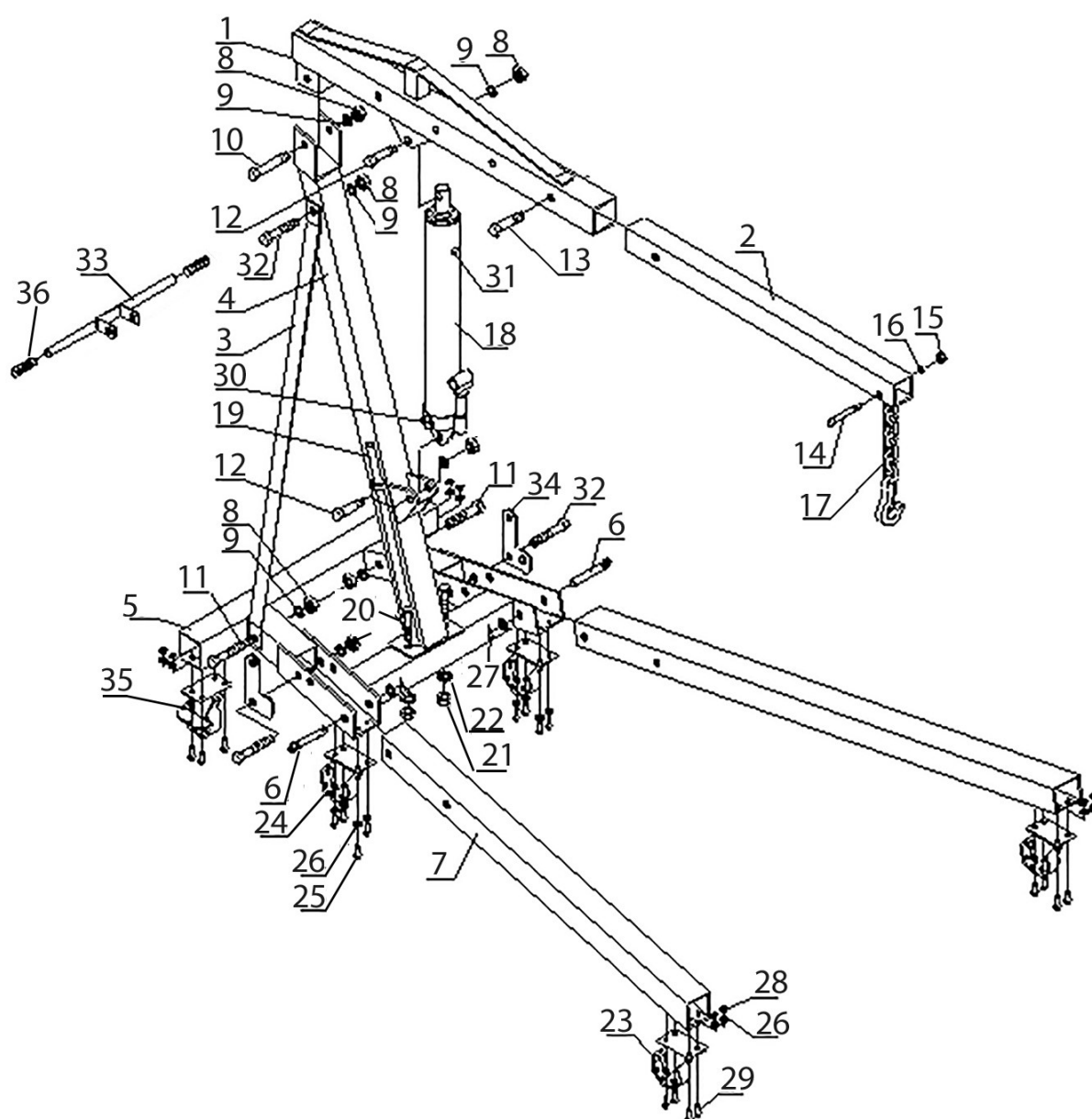

FRAME COMPONENT PARTS

NO	DESCRIPTION	QTY
1	Main jib	1
2	Jib extension	1
3	Support bar	2
4	Main support post	1
5	Base	1
6	Locating pin	2
7	Leg	2
8	Nut M16	7
9	Washer 16 dia	7
10	Bolt M16 x 115	1
11	Bolt M16 x 100	3
12	Bolt M16 x 90	2
13	Locking pin	1
14	Bolt M14 x 80	1
15	Nut M14	1
16	Washer 14 dia	1
17	Hook and chain	1
18	Pump assembly	1

NO	DESCRIPTION	QTY
19	Handle	1
20	Bolt M14 x 100	2
21	Nut M14	2
22	Washer 14 dia	2
23	Castor (3.5 in)	4
24	Castor (2.5 in)	2
25	Bolt M8 x 12	8
26	Washer 8 dia	24
27	R-clip	4
28	Nut M8	16
29	Bolt M8 x 20	16
30	Release valve	1
31	Oil filler plug	1
32	Bolt M16 x 110	3
33	Handle	1
34	L-shaped Leg support plate	2
35	Castor with brake	2
36	Rubber grip	2

ASSEMBLY

Using a clean level area, unpack, check and identity all components including nuts, bolts and washers. Lay out the main components roughly as shown in parts diagram on page 5.

During assembly, nuts and bolts should only be finger tightened unless otherwise specified. Final tightening can be carried out when assembly is completed.

Where bolts are mentioned, it is assumed that the appropriate washers and nuts are also fitted.

REFER TO PARTS DIAGRAM ON PAGE 5 AND LIST ON PAGE 6

1. Locate each front leg (7) into the openings provided in the Base Frame (5). Ensure the leg extension bolts (6) are on the inside of the legs.

2. Bolt the castor wheels to the base frame and leg extensions. The two smaller castors (24) locate at the middle of the assembly and the two larger items with brakes (35) are installed on the base frame (where the operator will use them).
3. Position the Main Support Post (4), over the holes provided, so that the Hydraulic Ram Assy bracket on the main support is facing towards the front wheels. Secure using bolts (20).
4. Connect the support bars (3), to their upper mountings at either side of the main support post with bolts (32). Connect the support bars to the Base with bolts (11), nuts and washers. Add the leg storage brackets (34) to the sides of the Base. Fully tighten all nuts and bolts assembled used so far.
5. Fit the Hydraulic Pump/Ram assembly (18), (with ram piston uppermost), into its mounting on the Main Support Post. Having lined up the hole in the bracket with that in the ram assembly, insert bolt (12) and tighten fully. Be careful not to over-tighten and clamp the pump/ram assembly. Allow the ram assembly to rest against the support post.
6. Lift the jib (1) into position in its mounting on top of the main support post and secure with bolt (10).
7. Raise the jib and manoeuvre the hydraulic ram assembly until the ram enters the bracket under the jib. Line up the holes in the bracket and ram and insert bolt (12). It may be necessary to extend the ram to facilitate its location.
8. To do this, ensure the control valve on the side of the ram assembly is closed by turning it firmly clockwise using the notched end of the pump handle. Pump the handle until the ram extends by the required amount.
9. Raise the jib to a horizontal position using the hydraulic ram and insert the Jib Extension (2) to any selected length (see OPERATION page 8).

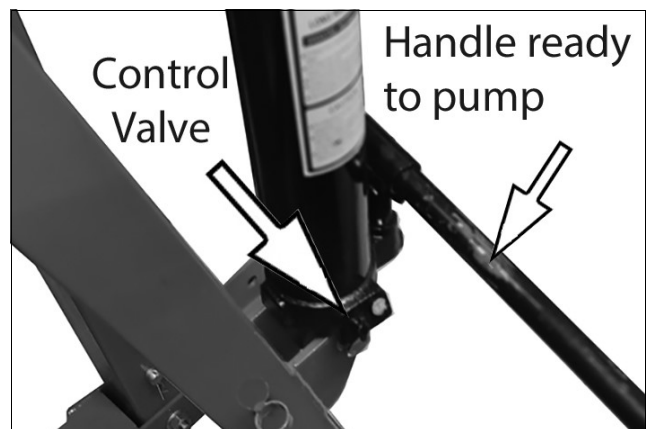

- Ensure that the slot at one end of the extension is outermost and on its underside.
10. Slide the jib extension in as far as convenient and secure in position with the R-clip provided.
 11. Fit the chain and hook assembly (17) to the end of the jib extension by sliding the end chain link into the slot provided and threading the bolt (14) through the locating hole and chain link.
 12. Finally check to ensure that all nuts are fully tightened and the hydraulic ram assembly, wheels and castors, all operate freely.

NOTE: DO NOT OVERTIGHTEN ANY SECTION WHICH MAY CAUSE DISTORTION OR BINDING OF MOVING PARTS.

OPERATION



WARNING: WHEN REMOVING AN ENGINE, ENSURE THE VEHICLE IS WELL SUPPORTED AND SECURE. ALL ANCILLARY PARTS MUST BE DISCONNECTED, I.E. EXHAUST SYSTEM, ELECTRICAL CABLES AND HOSES, ETC. AND ONLY LIFTING POINTS RECOMMENDED BY THE VEHICLE MANUFACTURER SHOULD BE USED.

IMPORTANT: Make sure that the hook is directly above the point of lift, which in turn is directly above the centre of gravity of the load.

ALWAYS visually inspect the crane before use to ensure that all parts are correctly located and secure. Check for hydraulic leaks, signs of damage or worn parts and check the wheels and castors for serviceability.

RAISING THE JIB

To raise the jib arm, firstly locate the slotted end of the pump handle on to the hydraulic pressure release nut at the base of the ram assembly.

Turn the nut clockwise until tight, then remove the handle and locate it in the pump collar. Pump the ram to raise the jib to the required height.

LOWERING THE JIB

To lower the jib, locate the slotted end of the pump handle on to the pressure release nut and very slowly turn in an anticlockwise direction.

The jib will lower under its own weight. The more the valve is opened, the faster the load will lower. EXERCISE GREAT CARE WHEN LOWERING HEAVY LOADS.

EXTENDING THE JIB

1. Lift the jib to a horizontal position.
2. Remove the locating pin.
3. Reposition the jib extension to the desired length.

- The hole near the end of the jib extension will match the hole in the jib according to the weight being lifted. These are clearly marked.

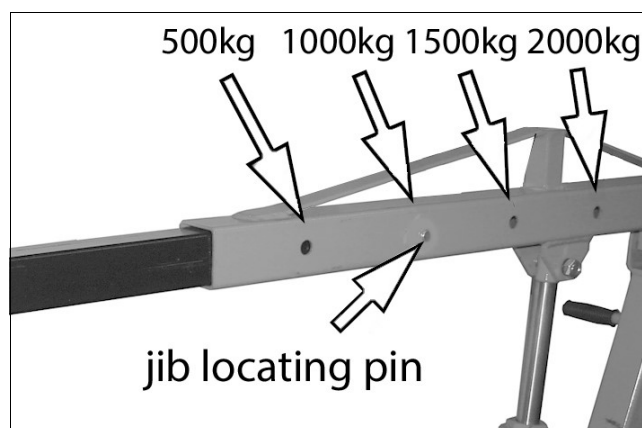

4. Replace the locating pin and secure with the R-clip provided.
5. Store the operating handle in the socket provided when not in use.

PURGING THE HYDRAULIC SYSTEM

During transit or storage it is possible that an air pocket may have developed within the hydraulic ram and the ram action may therefore appear to be 'spongy'. As the ram is self bleeding, any air will be dispelled and the ram action normalised by fully raising and lowering the jib a few times.

Should the jib not reach its full height, the oil level should be checked as described in the Maintenance section.

STORAGE & MAINTENANCE

STORAGE

1. **ALWAYS** store the crane with the jib in its lowest position. This prevents any possibility of corrosion to the ram.
2. **DO NOT** leave the crane in the open or exposed to the elements. Keep under cover.
3. Remove the pin and slide the jib extension back to its shortest position. Replace the pin and R-clip to secure the jib extension.
4. Release the control valve to lower the jib assembly to its lowest position.
5. Store the pump handle in its bracket on the side of the main support post.
6. Fold the unit in an upright position by removing the front pins from the base and raising the front legs to a vertical position. Insert the locking pins into the L-brackets to secure.
7. Replace the front pins into the holes in the base.

MAINTENANCE

1. The crane should be inspected periodically by a competent person with load bearing bolts should be removed and inspected for wear, deformation or cracks. If any are apparent the bolt should be renewed.
2. Check the hydraulic ram operation and inspect for oil leaks. A slight dampness on the ram is normal, but where leakage is apparent, the ram seals must eventually be renewed and the lost oil be replaced. Consult your CLARKE service department.



3. **DO NOT** attempt to adjust or tamper with the ram assembly. There are no user-serviceable parts. Contact your Clarke service department for any servicing.
4. Check the castors to ensure they move freely without undue wear to their spindles and that the wheels are not cracked or damaged.
5. Remove any rust and repaint to prevent further corrosion.
6. Ensure that all warning labels are in place and clearly legible.

HYDRAULIC OIL

If any leakage is observed, it may be necessary to top up the hydraulic oil as follows.

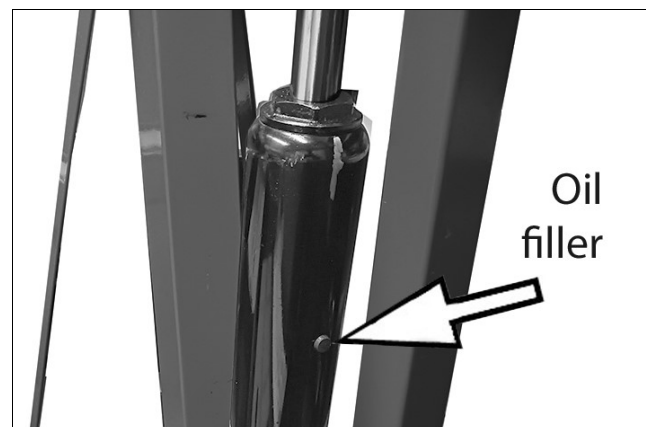
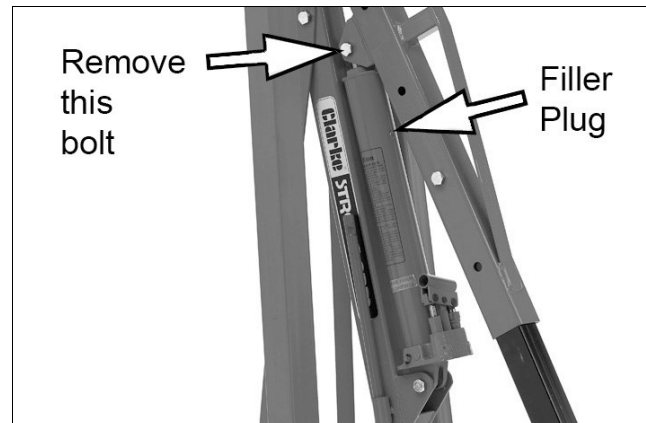

1. Lower the jib to its lowest position, and remove the bolt that joins the ram to the jib. This will allow the ram to fully retract and give access to the plug.
2. Remove the filler plug from the side of the ram and top up the oil until it is level with the hole. Replace the filler plug.

NOTE: Top up using Clarke hydraulic oil (part number 3050830). Do not mix different types of oil.

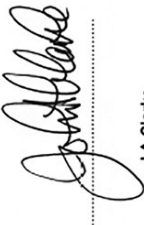

DECLARATIONS OF CONFORMITY

 Clarke[®] INTERNATIONAL Hemmill Street, Epping, Essex, CM16 4LG	DECLARATION OF CONFORMITY This is an important document and should be retained.
<p>We hereby declare that this product(s) complies with the following legislation: <i>The Supply of Machinery (Safety) Regulations 2008</i></p>	
<p>The following standards have been applied to the product(s): <i>BS EN 1494:2000+A1:2008, BS EN ISO12100:2010</i></p>	
<p>The technical documentation required to demonstrate that the product(s) meet(s) the requirement(s) of the aforementioned legislation has been compiled and is available for inspection by the relevant enforcement authorities.</p>	
<p>The UKCA mark was first applied in: 2024</p>	
Product Description:	Shop Crane
Model Number(s):	CFC2000B
Serial/Batch Number:	Refer to product/packaging label
Date of issue:	31/10/2024
Signed:	 J.A. Clarke Director
<p>CFC2000B UKCA Clarke DOC 103124</p> <p style="text-align: right;">Page 1 of 1</p>	

 Clarke[®] INTERNATIONAL Fitzwilliam Hall, Fitzwilliam Place, Dublin 2	DECLARATION OF CONFORMITY This is an important document and should be retained.
<p>We hereby declare that this product(s) complies with the following legislation: <i>2006/42/EC Machinery Directive</i></p>	
<p>The following standards have been applied to the product(s): <i>BS EN 1494:2000+A1:2008, BS EN ISO12100:2010</i></p>	
<p>The technical documentation required to demonstrate that the product(s) meet(s) the requirement(s) of the aforementioned legislation has been compiled and is available for inspection by the relevant enforcement authorities.</p>	
<p>The CE mark was first applied in: 2024</p>	
Product Description:	Shop Crane
Model Number(s):	CFC2000B
Serial/Batch Number:	Refer to product/packaging label
Date of issue:	31/10/2024
Signed:	 J.A. Clarke Director
<p>CFC2000B CE Clarke DOC 103124</p> <p style="text-align: right;">Page 1 of 1</p>	

A SELECTION FROM THE VAST RANGE OF

Clarke®

QUALITY PRODUCTS



AIR COMPRESSORS
From DIY to industrial, Plus air tools, spray guns and accessories.

GENERATORS
Prime duty or emergency standby for business, home and leisure.

POWER WASHERS
Hot and cold, electric and engine driven - we have what you need

WELDERS
Mig, Arc, Tig and Spot.
From DIY to auto/industrial.

METALWORKING
Drills, grinders and saws for DIY and professional use.

WOODWORKING
Saws, sanders, lathes, mortisers and dust extraction.

HYDRAULICS
Cranes, body repair kits, transmission jacks for all types of workshop use.

WATER PUMPS
Submersible, electric and engine driven for DIY, agriculture and industry.

POWERTOOLS
Angle grinders, cordless drill sets, saws and sanders.

STARTERS/CHARGERS
All sizes for car and commercial use.



PARTS & SERVICE:

0208 988 7400

Parts Enquiries
Parts@clarkeinternational.com

Servicing & Technical Enquiries
Service@clarkeinternational.com

SALES: UK 01992 565333 or Export 00 44 (0)1992 565335

Clarke® INTERNATIONAL Hemnall Street, Epping, Essex CM16 4LG
www.clarkeinternational.com